

The information contained in this drawing is the sole property of CWS Coil Winding Specialist. Any reproduction in part or whole without written permission of CWS Coil Winding Specialist is prohibited.

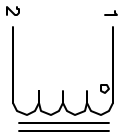

SCHEMATIC

- USING A PERMANENT MARKING METHOD MARK PART NUMBER AND REVISION, IF APPLICABLE
- IF NEEDED, WRAP INDUCTOR WITH GLASS TAPE

- TO THE CORE MUST REST FLAT ON PCB. LEADS MUST BE TANGENT FLUSH WITH THE COIL EDGE. AS SHOWN (I.E. COIL REMOVE INSULATION AND TIN LEADS 0.5 INCH

- WIND COILS EVENLY SPACED AROUND THE CORE CONSTRUCTION:

- HI-POT TEST FOR WINDING TO CORE ISOLATION = 500VDC MIN CURRENT RATING : 6.9 AMPS, 40 °C TEMP. RISE, NO AIR FLOW DCR = 22.0 MILLI-OHMS MAX. DC BIASED = 6.9 AMPS, INDUCTANCE = 42 UH DC BIASED = 12.0 AMPS, INDUCTANCE = 40 UH INDUCTANCE = 50 UH + 10% @ LOW DC BIAS, 1 KHz, 250mv
- SPECIFICATIONS:

- WIRE: UL RECOGNIZED 200°C RATED MAGNET WIRE CWS BYTE-MARK OR OTHER APPROVED PART CORE: COATED HIGH FLUX TOROIDAL CORE
- RATING CLASS B (130°C MIN.) REQUIRED MATERIAL: UL RECOGNIZED 94V-0 FOR FLAMMABILITY

NOTES: TOROIDAL POWER CHOKES. ALL DIMENSIONS IN INCHES

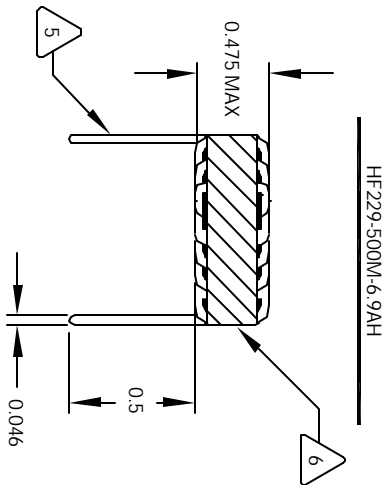

FRONT VIEW

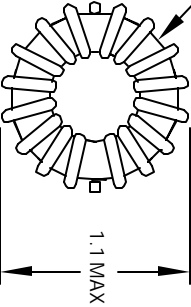

BOTTOM VIEW

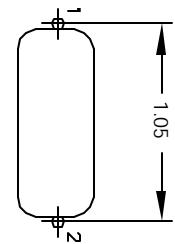

MOUNTING HOLES PATTERN

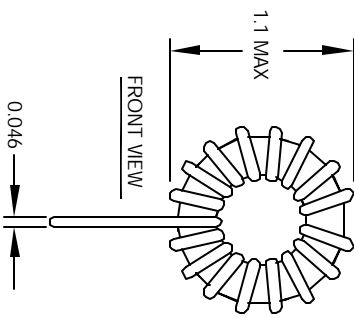

FRONT VIEW

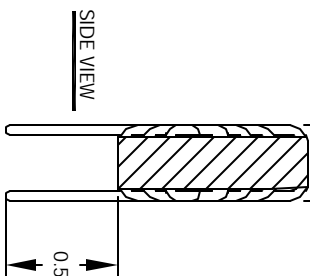

SIDE VIEW

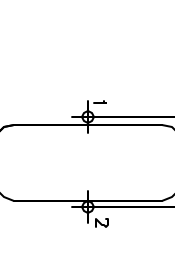

MOUNTING HOLES PATTERN

REVISION HISTORY			
REV	ECN	DESCRIPTION	DATE
A		PRODUCTION RELEASE	2/9/04

CODE IDENT	MFG. P/N	DESCRIPTION	ITEM NO.
AUTOCAD SOLIDWORKS	X		
UNLESS OTHERWISE SPECIFIED			
TOLERANCE PER AMS Y14.5M			
ALL DIMENSIONS ARE IN NOTES			
AND DIMENSIONS			
TOLERANCE INCHES			
XXXX±0.005			
TOLERANCE METERS			
XXXX±0.127			
ANGLE PROJECTION			
DO NOT SCALE DRAWING			

DATE	APPR.	DATE	APPR.
2/8/04	TKK	2/8/04	TKK
2/9/04	JLJU	2/9/04	JLJU
3/6/04	KSUU	3/6/04	JLJU
3/8/04	JLJU	3/8/04	JLJU

TITLE:	SIZE	DRW. NO.	REV
Toroidal Power Chokes	B	HF229-500M-6.9A	B
Toroid Inductor	B	HF229-500M-6.9A	B